

PP12/PM12 Series Sealed Pushbutton for Harsh Environment

Specifications

Features

- Robust design for marine or medical applications
- Double break action contact
- High shock and vibration resistant
- Positive tactile feedback
- Solder and screw terminals
- Meet Mil-PRF-8805 standard
- IP68S/IP69K rated

Housing Material	Thermoplastic/Anodized aluminum alloy
Button Material	Thermoplastic
Contact Resistance	<50mΩ (Initial)
Electrical Rating	0.1, 5A 125Vac, 0.1, 5A 64Vdc
Dielectric Strength	1000VAC for 1 minute between current carrying parts 2000VAC for 1 minute between non-current carrying parts
Operating Force	~1.7 lbs (7.6N) or ~0.8 lbs (3.6N)
Operating Temperature	-40~+85°C (-40~185°F)
Mechanical Life	1 million (operations)
Electrical Life (@28VDC or 115VAC)	Resistive load 5A 25,000 (operations) Inductive load 3A 25,000 (operations)
Degree of Protection	IP68S/IP69K

Selection Guide:

PP12	L - 1		- M	1	1	L	1	- B	- B - 12		R - K - U6		
Housing Material	Illuminated (optional)	Body Style	Maintained (optional)	Terminal Style	Low force (optional)	Bezel Color	Button Color*	Nuts	Rubber Cap* (Optional)	LED Voltage	LED Color*	Gold Plated (optional)	Wire Length
P: Thermoplastic		1: Flush Head, Threaded Case	1: Solder/Std.	1: 1NO 2: 1NC 3: 1NO/1NC	1: Silver 2: Black	Blank: Plastic nuts M: Metal nuts	Blank: None 3: 3V 6: 6V 12: 12V 24: 24V 48: 48V 120: 120V 240: 240V	Blank: No wire U6: 6 inches F2: 2 feet M05: 0.5 meters					
		2: Raised Head, Threaded Case	2: Screw/Std.										
		3: Flush Head, Snap-In Case	3: Solder/Short										
		4: Raised Head, Snap-In Case	4: Screw/Short										
		5: Small Head, Flush, Threaded Case	5: .250" QC										
		6: Small Head, Raised, Threaded Case	6: .110" QC										
		7: Front-panel Threaded											

Pictures and Dimensions:

* Color code: B for Black, G for Green, R for Red, Y for Yellow, O for Orange, U for Blue, W for White, P for Purple, A for Gray

PP12-1-112-G

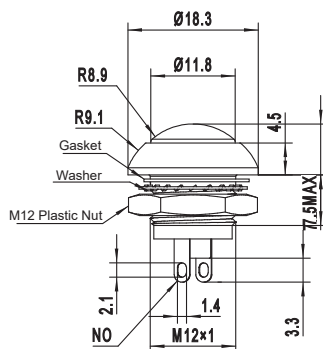

PP12-1-112-R-U6

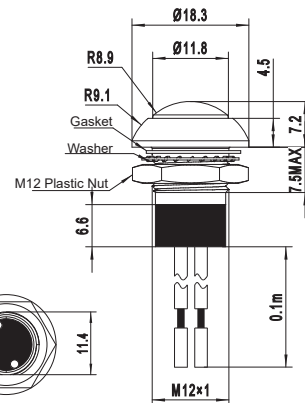

PP12-2-112-B

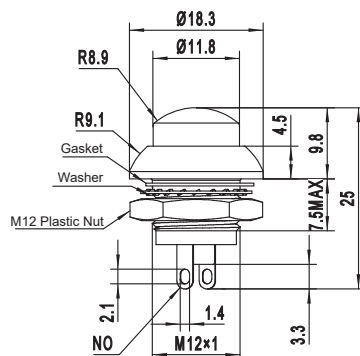

PP12-3-112-B

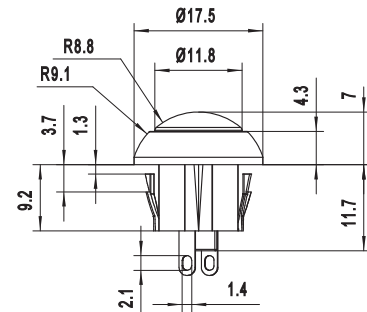

PP12-1-112-BB



Accessory Dimensions:

